

# MoliCare Premium Form Fitting guide



Open the product and fold it in half lengthwise to activate the inner cuff system.

The smaller absorbent area of the product should be positioned at the front of the body.



## Lying

Place the fixation pants with the waist elastic around the knees and turn the patient on to his/her side.

While folded, apply the product from front to back. Pull the product up in to the groin.



Unfold the product at the rear and make sure that the wetness indicator is in line with the spine.

Pull up the back of the fixation pants and turn the patient over on his/her back.



Unfold the product at the front and ensure that the leakage guards are facing up.

Pull up the fixation pants.



Make sure that product and fixation pants fit snugly while smoothing out all wrinkles and folds.



## Standing

Place the fixation pants with the waist elastic around the knees.

While folded, apply the product from front to back. Pull the product up in to the groin.



Unfold the product at the rear and make sure that the wetness indicator is in line with the spine.



Pull up the back of the fixation pants.



Unfold the product at the front and ensure that the leakage guards are facing up.

Pull up the front of the fixation pants.

Make sure that product and fixation pants fit snugly while smoothing out all wrinkles and folds.

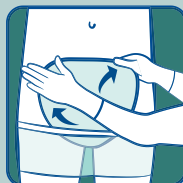

**Perform perineal care after each incontinent episode and/or with each product change.**

[www.hartmann.com.au](http://www.hartmann.com.au)

PAUL HARTMANN Pty Ltd. ABN 35 000 099 589 Level 5, 1 Thomas Holt Drive Macquarie Park  
NSW 2113 © Registered trademark PAUL HARTMANN AG. 9166041



Watch the  
application  
video



Going further  
for health