

MoliCare® Premium Slip Application Technique

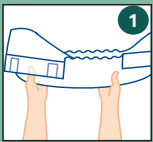

Laying Position



1 Fold the product in half lengthwise with the backsheet facing the outside ensuring the leakage guards are turned up.

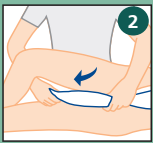

2 While folded, insert or apply the product from the front to the back.

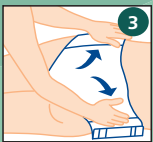

3 During this process, pull the product up in to the perineal area centering it front to back.



4 Unfold, spread & centre the product across the back-side. The wetness indicator should be in line with the spine.



5 Apply the upper tabs at a 45° downward angle. Stretch the flexible tabs slightly before taping.



6 Apply the lower tabs at a 45° upward angle, while tucking the front wings smoothly in & under the back wings.

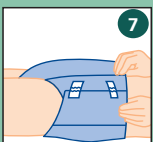

7 Smooth out all wrinkles & folds while checking the fit of the product. Adjust as required.

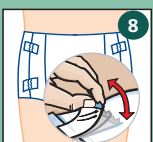

8 You can check and refasten the product multiple times.

Standing Position

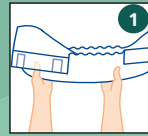

1 Fold the product in half lengthwise with the backsheet facing the outside ensuring the leakage guards are turned up.

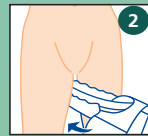

2 While folded, insert or apply the product from the front to the back. Pull the product up in to the perineal area centering it front to back.



3 Open out the back of the product so that the wetness indicator lies along the spine.

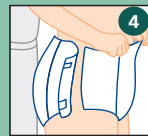

4 Unfold, spread and center the product at the front. The inner leak guards should now lie comfortably in the groin area.

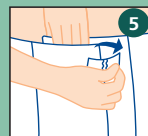

5 Apply the upper tabs at a 45° downward angle. Stretch the flexible tabs slightly before taping.

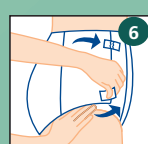

6 Apply the lower tabs at a 45° upward angle, while tucking the front wings smoothly in & under the back wings.

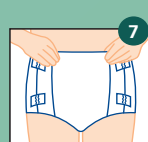

7 Smooth out all wrinkles & folds while checking the fit of the product. Adjust as required.

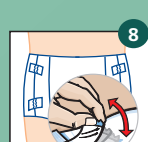

8 You can check and refasten the product multiple times.

Perform perineal care after each incontinent episode and/or with each product change.



www.hartmann.com.au

PAUL HARTMANN Pty Ltd. ABN 35 000 099 589 Level 5, 1 Thomas Holt Drive Macquarie Park NSW 2113.
© Registered trademark PAUL HARTMANN AG. 9166042

For further information on HARTMANN Continenace and Skin Care products please contact your local Representative or call HARTMANN customer care toll free **1800 805 839**