

MoliCare® Premium Elastic

Fitting Guide - Standing Position



How to select the correct size to ensure maximum comfort and leakage protection:

- Measure the largest width between the waist and hips.
- Select the product size based on the size guide printed on the product packaging.

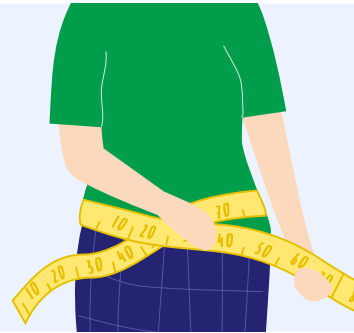

Waist Measurement	Size
70 - 90 cm	S
85 - 120 cm	M
115 - 145 cm	L
140 - 175 cm	XL

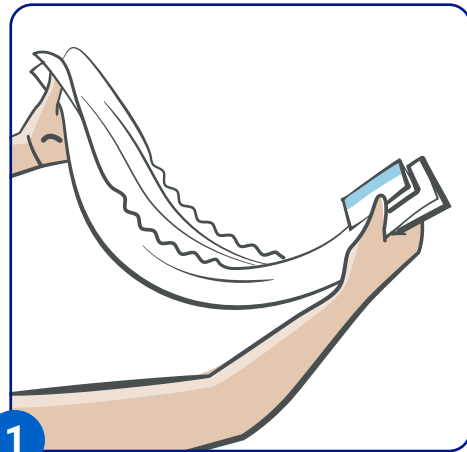

1

Fold and cup the pad to get it ready for application.



2

Stand beside the person. Slide the pad between the legs from the front to the back.

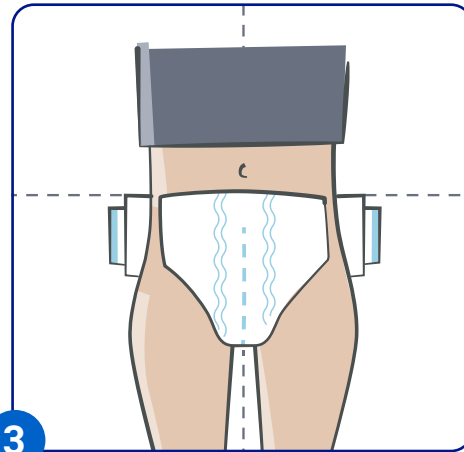

3

Ensure that the pad is centered in correct position by aligning the wetness indicator with the spine.

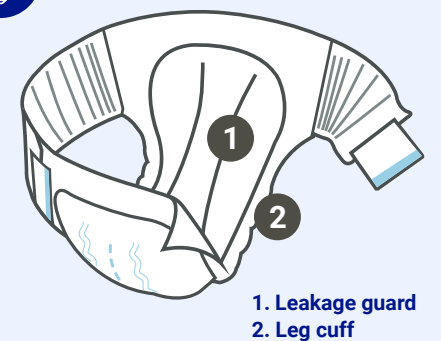

1. Leakage guard
2. Leg cuff

Ensure leg cuffs (2) are turned out and not covering the leakage guards (1). If leakage guards are covered, leakage will occur.

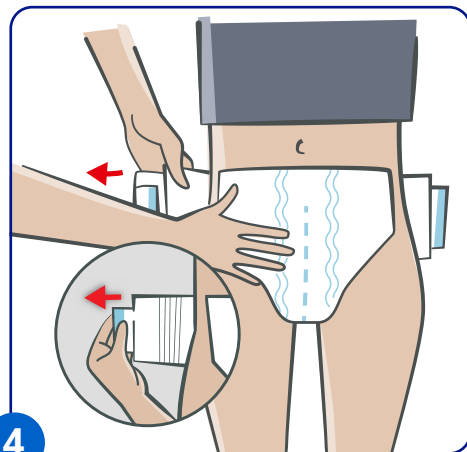

4

Fold out elastic side panels and wrap around person's hip.

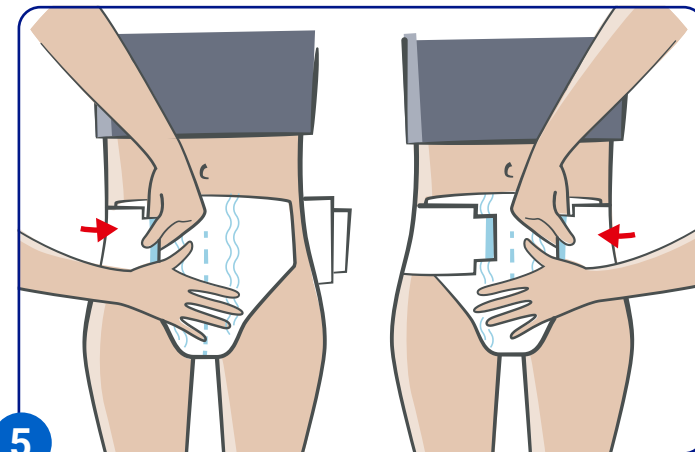

5

Secure adhesive tapes into position.

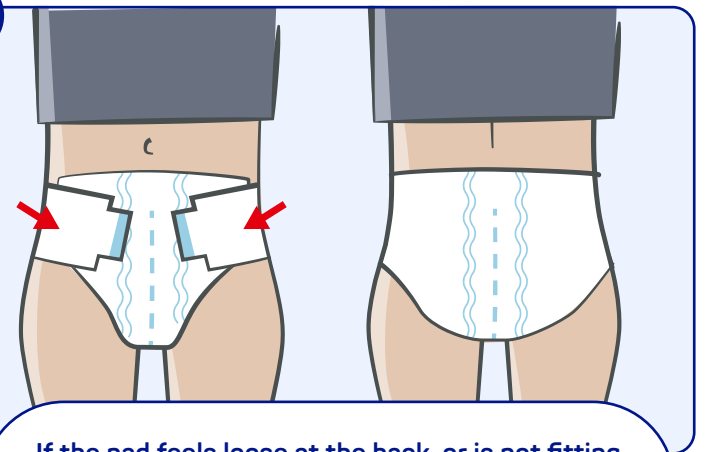

If the pad feels loose at the back, or is not fitting well, try applying the tabs at a downward angle to help conform to different body shapes.

Key benefits & principles



Caregiver

Ergonomics in the workplace

Faster application reduces handling & physical stress.*



Patient

Comfort & Security

Elastic flexibility allows people to wear the product with improved comfort and security.

Improved Hygiene

Removing the pad from the back ensures lower risk of faecal contamination.

Dignity

Quick, easy application and the ability to reposition tapes reduces changing times.

*Laboratory report about ergonomic evaluation of MoliCare variants A+B incontinence products. Research conducted between 5 - 8 October 2015 in Dijon, France. W. Schneider, H. Mutschler, R. Haller, C. le Mathe. Comparison with a slip having 4 side panels and 4 tapes.



Scan the QR code or go to moli.care to watch MoliCare application videos.



usl **medical**

uslcustomerservices@uslmedical.co.nz | 0800 658 814

uslmedical.co.nz

05.2023

MoliCare® Premium Elastic

Fitting Guide - Laying Position



How to select the correct size to ensure maximum comfort and leakage protection:

- Measure the largest width between the waist and hips.
- Select the product size based on the size guide printed on the product packaging.

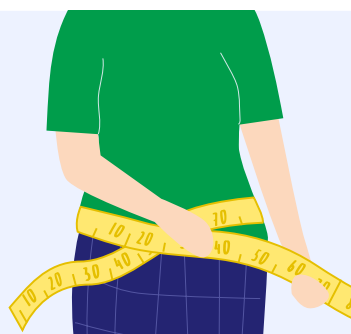

Waist Measurement	Size
70 - 90 cm	S
85 - 120 cm	M
115 - 145 cm	L
140 - 175 cm	XL

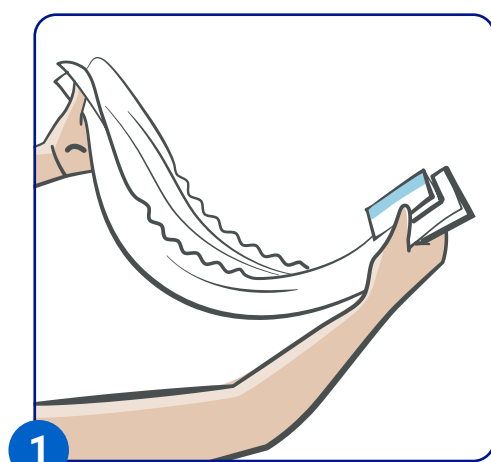

1

Fold and cup the pad to get it ready for application.

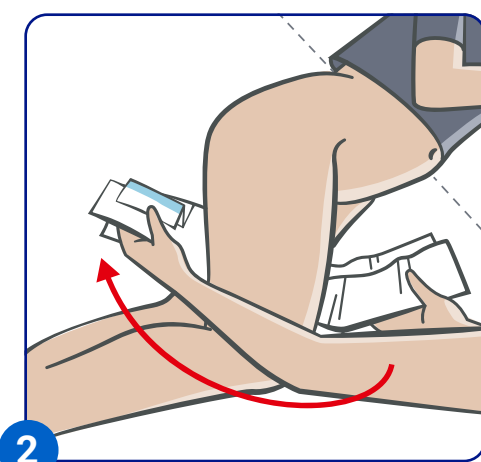

2

Turn the person into recovery position and stand beside them. Slide the pad between the legs from the front to the back.

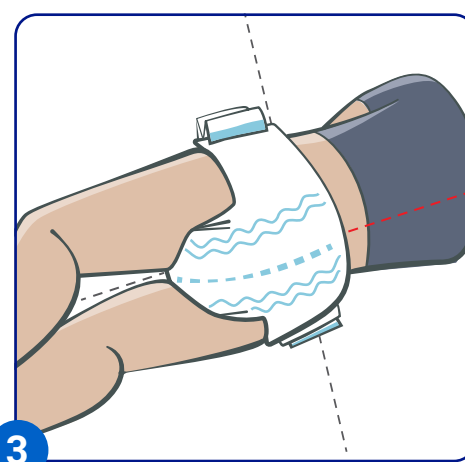

3

Ensure that the pad is centered in correct position by aligning the wetness indicator with the spine.

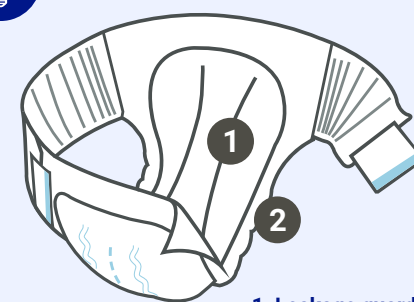

1. Leakage guard
2. Leg cuff

Ensure leg cuffs (2) are turned out and not covering the leakage guards (1). If leakage guards are covered, leakage will occur.

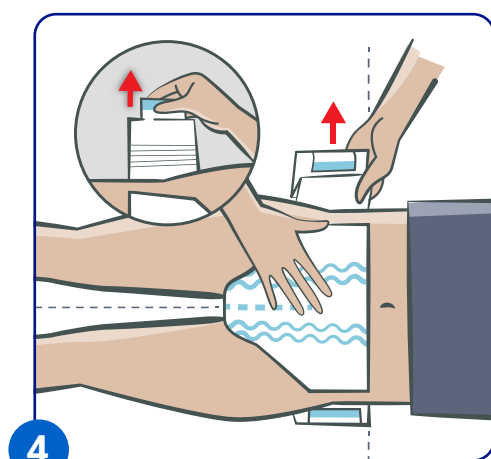

4

Fold out elastic side panels and wrap around person's hip.

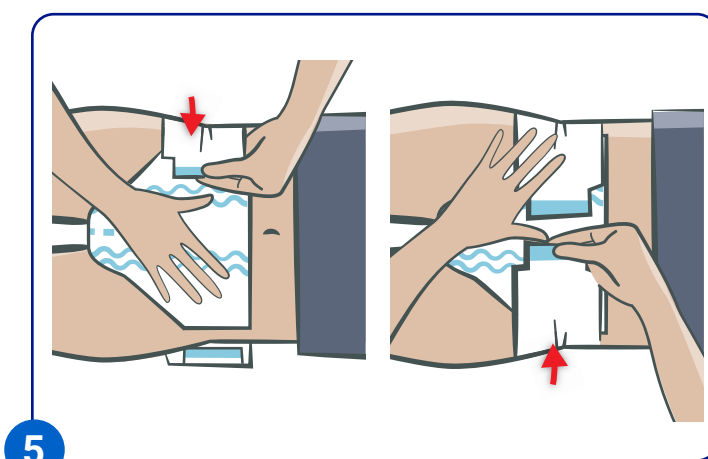

5

Secure adhesive tapes into position.

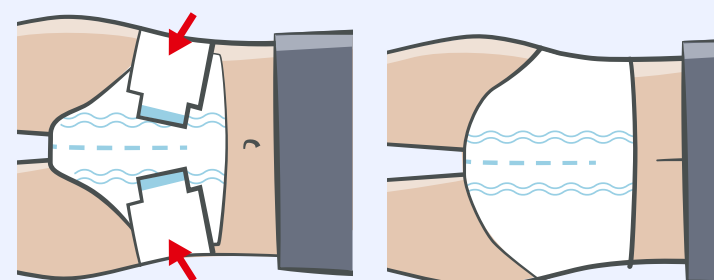

If the pad feels loose at the back, or is not fitting well, try applying the tabs at a downward angle to help conform to different body shapes.

Key benefits & principles



Caregiver

Ergonomics in the workplace

Faster application reduces handling & physical stress.*



Patient

Comfort & Security

Elastic flexibility allows people to wear the product with improved comfort and security.

Improved Hygiene

Removing the pad from the back ensures lower risk of faecal contamination.

Dignity

Quick, easy application and the ability to reposition tapes reduces changing times.

*Laboratory report about ergonomic evaluation of MoliCare variants A+B incontinence products. Research conducted between 5 - 8 October 2015 in Dijon, France. W. Schneider, H. Mutschler, R. Haller, C. le Mathe. Comparison with a slip having 4 side panels and 4 tapes.



Scan the QR code or go to moli.care to watch MoliCare application videos.



usl **medical**

uslcustomerservices@uslmedical.co.nz | 0800 658 814

uslmedical.co.nz

05.2023